



पादप कार्यिकी संभाग
DIVISION OF PLANT PHYSIOLOGY
भारतीय कृषि अनुसन्धान संस्थान
ICAR-Indian Agricultural Research Institute
नई दिल्ली - 110012 भारत
NEW DELHI - 110 012 (INDIA)



File No: 50-20/FF/20-21/NAHEP(71-01)

Date: 18/02/2021

Dear Sirs,

**Sub : Invitation of Quotations for supply of
Furniture and Fixtures for Big Data Lab of NAHEP-CAAST**

1. You are invited to submit your most competitive quotation for the following goods:-

Brief Description of the Goods	Specifications*	Quantity*	Delivery Period	Place of Delivery	Installation Requirement if any
Furniture and Fixtures for Big Data Lab	Annexure – I, IIa and IIb		90 days after issue of Purchase/Supply Order	Division of Plant Physiology, IARI, Pusa Campus, New Delhi - 110012	As per terms and conditions.

* Where ISI certification marked goods are available in market, procurement should generally be limited to goods with those or equivalent marking only.

2. Government of India has received a financing from the World Bank towards the cost of the _____ Project and intends to apply part of the proceeds of this financing to eligible payments under the contract for which this invitation for quotations is issued.

3. **Bid Price**

- The contract shall be for the full quantity as described above. Corrections, if any, shall be made by crossing out, initialing, dating and re writing.
- All duties, taxes and other levies payable on the raw materials and components shall be included in the total price.
- Sales tax in connection with the sale shall be shown separately.
- The rates quoted by the bidder shall be fixed for the duration of the contract and shall not be subject to adjustment on any account.
- The Prices shall be quoted in Indian Rupees only.

4. Each bidder shall submit only one quotation. Bidder shall not contact other Bidders in matters relating to this Quotation.

5. **Validity of Quotation**

Quotation shall remain valid for a period not less than 15 days after the deadline date specified for submission.

6. **Evaluation of Quotations**

The Purchaser will evaluate and compare the quotations determined to be substantially responsive i.e. which

- (a) are properly signed ; and
- (b) conform to the terms and conditions, and specifications.

The Quotations would be evaluated for all the item together/would be evaluated separately for each item. *[Select one of the options]*.

Sales tax in connection with sale of goods shall not be taken into account in evaluation.

7. **Award of contract**

The Purchaser will award the contract to the bidder whose quotation has been determined to be substantially responsive and who has offered the lowest evaluated quotation price.

7.1 Notwithstanding the above, the Purchaser reserves the right to accept or reject any quotations and to cancel the bidding process and reject all quotations at any time prior to the award of contract.

7.2 The bidder whose bid is accepted will be notified of the award of contract by the Purchaser prior to expiration of the quotation validity period. The terms of the accepted offer shall be incorporated in the supply order.

8. Payment shall be made only after the receiving of Good/Equipment, Performance Guarantee and satisfactory installation.

9. Normal commercial warranty/ guarantee shall be applicable to the supplied goods.

10. You are requested to provide your offer latest by **13.00 hours on 05/03/2021**.

11. We look forward to receiving your quotations and thank you for your interest in this project.

(Purchaser)

Name: Assistant Admn. Officer.

Address: Division of Plant Physiology,
IARI, Pusa Campus,
New Delhi - 110012

Tel. No. 011 25842815.

Fax No.

Annexure-I**Specifications of furniture and fixtures**

S.N.	Furniture description	Units	Qty.
1	Modular Workstation		
	Providing and placing Modular Workstation top made of 25mm thick prelaminated particle board duly edge banded. Partition panel of 60mm thick &ht 1200mm with fabric/writing plain marker board above the work top. Also it has a Fixed 3 drawer unit with 2 drawer and one filling drawer having telescopic channels, CPU Trolley & Keyboard Tray. 1050x600x750mm (WxDxH) (Quantity- 13) 1200x1500/600x750mm (WxDxH) (Corner table) (Quantity- 2) 730x600x750mm (WxDxH) Printer space (Quantity- 1)	No.	15
2	Workstation Chair		
	Providing and Placing Workstation Chair revolving Medium back of overall height 41" overall depth of seat 19" and overall width 19" seat & back made of 12mm molded ply with high density back and PU molded seat cushion, having PU arm rest with ABS seat & back and 5 pronged PPbase with syncro tilt mechanism with movement of 2:1 ratio and fitted with rheumatic height adjustable with gas lift mechanism. The chair is uphosted with good quality fabric.	No.	40
3	Conference Table		
	Conference Table of Size 3000x1200x750mm (WxDxH). Top made in 25mm thick Medium Density pre laminated board duly edge banded and side cover and modety panel made of 18mm thick medium density prelaminated board with lipping of 2mm, the base frame shall be made of SS 202 grade of size 50x25x1.2 mm duly polish. (12 Seater)	No.	1
4	Table		
	Providing and Placing Table of size 900x600x750mm (WxDxH) Top made of 25mm prelaminated particle board with PVC lipping at the borders. Frame made of 25mm square pipe not less than 16 gauge duly powder coated up to 40-45 microns. Provision of three-drawer unit on one side made in 24 gauge, duly powder coated. The table is provided with duplicate SS keys for drawers.	No.	1
5	Overhead Unit		
	Providing and Fixing Overhead unit of size 900x450x900mm (WxDxH). Body made in 0.8mm thick CRCA sheet duly powder coated with anti-rust treatment and doors are 18mm thick prelaminated particle board with 4mm glass . It has a provision of adjustable shelves having two compartment.	No.	6
6	Sofa Set (Seater 3 +1+1) with Centre Table	set	1
7	Almirah (Steel hinge door)		

	Providing and Placing Steel hinge door almirah of size 915x480x1980mm (WxDxH).Body made in CRCA22 gauge and shutter made up 20gauge with locking arrangement and 4 shelves, 5 compartment duly powder coated 9 tank treatment.	No.	2
8	Rack (Open)		
	Providing and Placing Steel hinge door almirah of size 600 x 480 x 1980 mm (w x d x h). Body made in CRC A22 gauge and shutter made up 20 gauge with locking arrangement and 4 shelves, 5 compartment duly powder coated 9 tank treatment.	No.	1
9	Regent Rack		
	Providing and Placing Regent Rack of size 6900x600x750mm (WxDxH) having one shelf. It has a partition in the middle of the shelf to keep the regent properly. the corners of the racks are duly woodedge banded and polished. The complete Regent Rack are made in19 mm thick with. 8 mm thick laminate / mica of standard make in approved shade.	No.	1
10	Lab Stool		
	Providing Lab revolving stool having 12mm ply for seat & back with 40 density U foam with leathrite. Base in 40 to 45 micron duly powder coated. There is ring for foot rest with adjusters at the bottom. Height is from 20" - 25" inch (adjustable) with hydraulic mechanism.	No.	13
11	Reception counter		
	Reception Counter of Size 1800 x 600 x 750 / 1050 mm (WxDxH) with complete in 18mm thick block board with one mm veneer duly melamine polished.	No.	1
12	Round Table		
	Round Table of size 750 mm diameter having 25mm thick edge banded round. Pre laminated particle board top top. Base of SS 202 grade round pipe.	No.	3
13	Executive Table With side table		
	Providing and Placing Executive Table of size 1500 x 750 x 750 mm (WxDxH)with side unit of size 900 x 450 x 570 mm (WxDxH) having top made in 25mm thick pre laminated particle board duly edge banded and base made in18 mm thick pre laminated particle board duly edge banded.	No.	1
14	Providing and Placing soft Board.	No.	5
15	Providing and placing Glass fin 10mm thick of size 450mm X 600mm (H X D)	No.	5
16	CPU Trolley		
	Providing CPU trolley made of CRCA in 22 gauge duly powder coated upto 40 microns with lockable nylon wheel castors	No.	6
17	Partition Panel of size 60mm thick and height 1200mm with fabric having raceway at two levels, one at skirting and one above / below the worktop sizes are 1200X1200X60 mm 2 Nos. and 1200X600X60mm, 1 Nos.	No.	1

Terms and Conditions

1. The Bidder should be Furniture Manufacturer (OFM) of the office furniture products.
2. Bidder should have at least 5 years experience (document must be attached in support) of setting up and running of similar work.
3. The proper documentary proof (i.e. Factory License, EPF Registration, ESIC Registration, Trade Mark Certificate for their Brand Name, MOA of company) should be enclosed with tender bid.
4. Bidder must have following certificates with the pre-qualified documents.
 - i. ISO 9001-2015
 - ii. BIFMA Membership Certificate
5. Bidder should possess GST Registration, Certificate of Incorporation, Provident Fund Certificate, Employee State Insurance Corporation certificate.
6. The bidder should be enclosed the documentary proof of up-to date GST return, EPF challan and ESIC challan with tender bid.
7. The Bidder should quote for all items of the tender. Any tender for Part item will be rejected out rightly.
8. Income Tax Return of last 3 years. Physical submission of documents mentioned on prescribed date before opening the tender is mandatory. Other documents also have to be submitted with the department before opening of the tender. However, the tender opening authority reserves the right to evaluate a tender as technically responsive if any of above document is not enclosed with the bid.
9. The product should carry a warranty of One year and an undertaking on the company letter head should be submitted by the bidder with tender.

Furniture Layout for Wet Lab

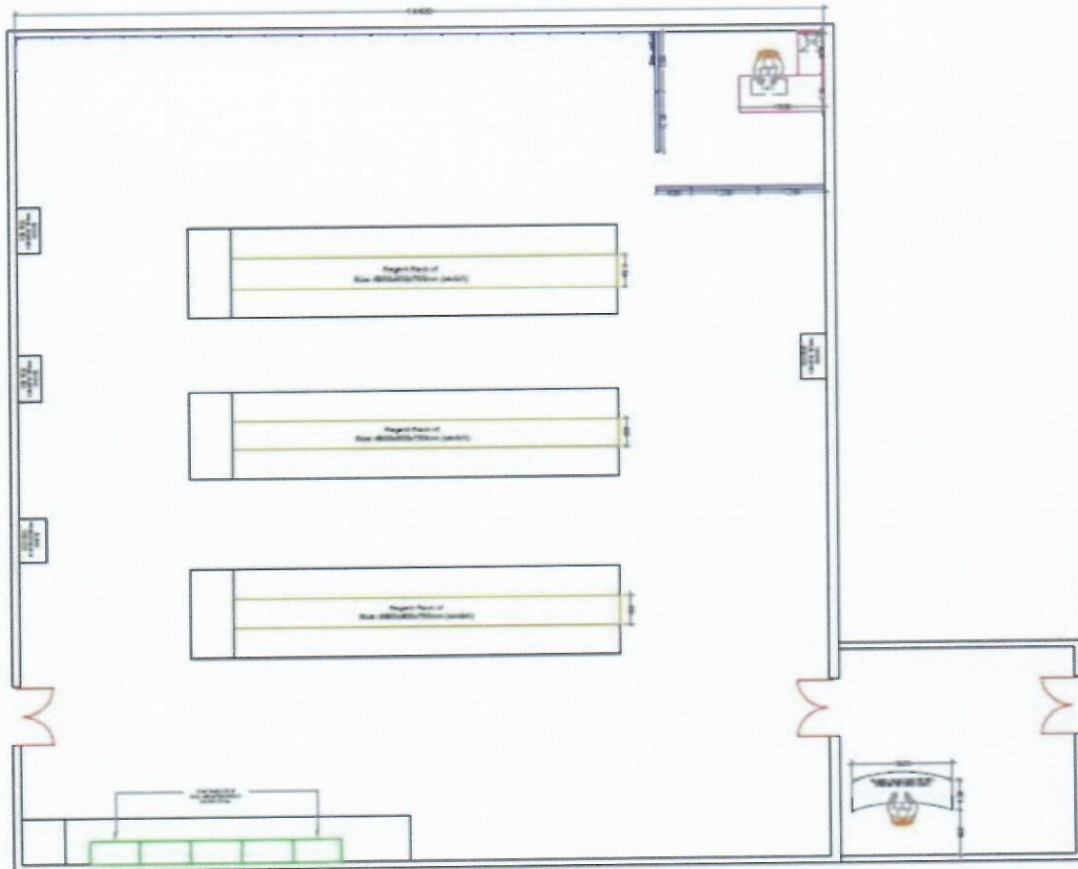

Layout for lab furniture: Big Data Analytics

